

5. Blank Form

Inquiry Order No.: _____

Tool type

- with solid carbide drill head (Type 100)
- in solid carbide version (Type 110)
- drill head with inserted carbide bearing pads (Type 120)

Coating

- Yes Coating Type: _____
- No _____

Driver

- Driver No. _____
- without
- Special driver as per drawing

Tool dimensions

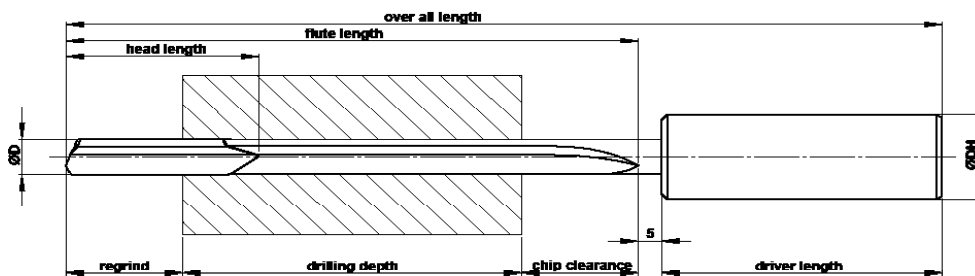

Nose grinds

- Standard nose grind see brochure
- Special nose grind as per drawing

please fill in

Calculation of Tool length [mm]

| Drill-Ø | 0,9-1,899 | 1,9-2,499 | 2,5-3,099 | 3,1-5,099 | 5,1-8,099 | 8,1-18,099 | 18,1-30,0 |
|------------------------|-----------|-----------|-----------|-----------|-----------|------------|-----------|
| Regrind approx. | 12 | 12 | 14 | 15 | 20 | 30 | 30 |
| Chip clearance approx. | 20 | 22 | 25 | 30 | 35 | 55 | 70 |

Consider machine-dependent lost length

Information about holes

- through holes
- blind holes
- angular inlet/outlet as per drawing
- cross holes as per drawing

Material

Material-No. _____ Description _____ Hardness _____

Machine

- Gundrilling machine
- Machining center
- workpiece is rotating
- tool is rotating
- both rotate

Coolant

- Deep-hole drilling oil
- Emulsion
- Atomized spraymist

Cooling lubricant _____ coolant pressure _____ bar

Quantity

Delivery date

_____ piece(s)

week _____

Customer data

Customer _____

Company Stamp

Address _____

Phone/Fax _____

Contact _____

Date/Signature _____

E-Mail _____